

ERF6023, RF connector, SMA Female, PCB End Launch

**Features**

**Mechanical Properties**

Parameter:	Description
Connector Type:	SMA Female PCB End Launch
Dimensions:	14.28 x 9.52 x 7.92 mm ± 0.1
Operating Temperature Range:	-65°C~+165°C
Storage Temperature Range:	-65°C~+165°C
Impedance:	50 Ω
Frequency Range:	0 – 6GHz
VSWR:	1.5 max.
Working Voltage:	500Vrms @sea level
Insulation Resistance:	5000 Ω min.

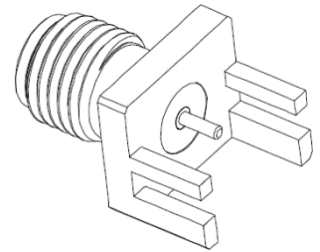

**Typical applications**

- RF connections
- Antenna connector
- Antenna cable connector

**Description**

The ERF6023 is a RF connector suitable for RF applications. The connector is a SMA Female PCB end launch connector. It can be used for RF connections and as antenna connector.

**Dimensions**

\*unit: mm

Part	Description	Material	Finish
1	Body	Brass	Gold
2	Insulator	Teflon	White
3	Contact Pin	Brass	Gold

ERF6023, RF connector, SMA Female, PCB End Launch

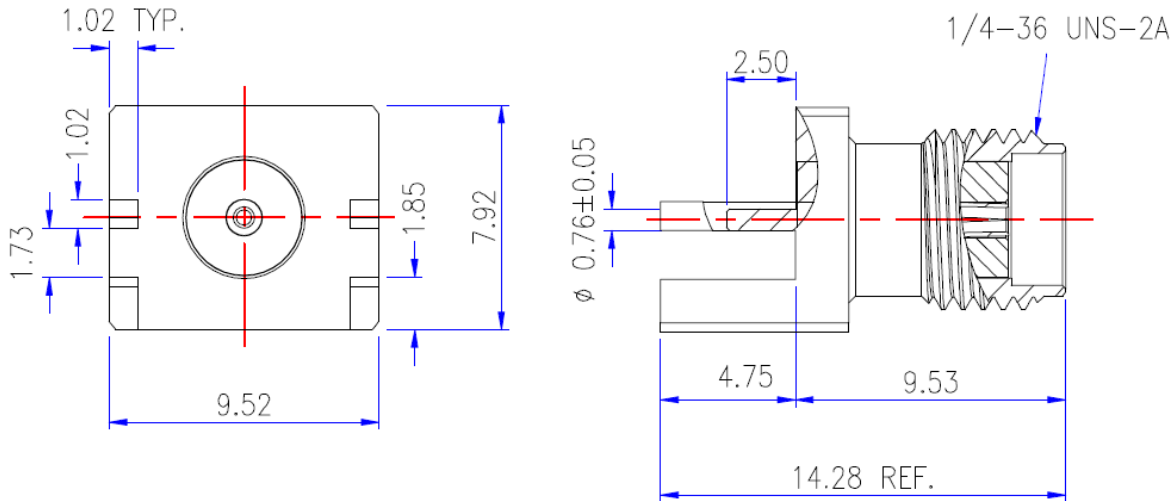

**PCB Footprint**

\*unit: mm

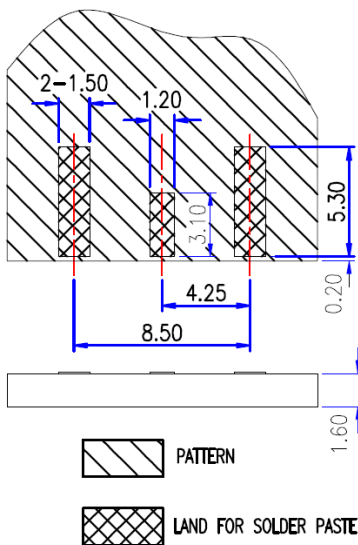

**Ordering information**

Ordering can be done via [www.summit-electronics.com](http://www.summit-electronics.com) or via [info@summit-electronics.com](mailto:info@summit-electronics.com). Please contact us for more information. Customisation of the product is available on request.

**Technical support**

For all product questions please contact us via [info@summit-electronics.com](mailto:info@summit-electronics.com)